





KEY FEATURES

- Lift access
- Air conditioning
- Porter
- South-facing views of Green Park

This well-presented three-bedroom apartment is situated on the fifth floor of 89 Piccadilly, offering south-facing views over Green Park. Spanning 1,061 sq ft, the property includes a spacious open-plan reception and dining area, a separate kitchen, and three double bedrooms. The principal bedroom benefits from an en suite, while a family bathroom serves the remaining two bedrooms.

The apartment has been newly refurbished and features lift access, air conditioning, and a porter. Positioned in a superb location, the property enjoys excellent natural light and direct views over Green Park.

Ideally located in the heart of Mayfair, resident's of the building benefit from the abundance of luxurious boutique shops, up-market restaurants and 5* hotels. Hyde Park Corner Underground Station (Piccadilly lines) and Green Park Underground station (Jubilee, Piccadilly and Victoria lines) and both a short stroll away.



3 BEDROOM



2 BATHROOM





ACCOMMODATION

Reception/dining room

Separate kitchen

Principal bedroom with en suite

Two further double bedrooms

Family bathroom

LOCATION

Ideally located in the heart of Mayfair, resident's of the building benefit from the abundance of luxurious boutique shops, up-market restaurants and 5* hotels. Hyde Park Corner Underground Station (Piccadilly lines) and Green Park Underground station (Jubilee, Piccadilly and Victoria lines) and both a short stroll away.

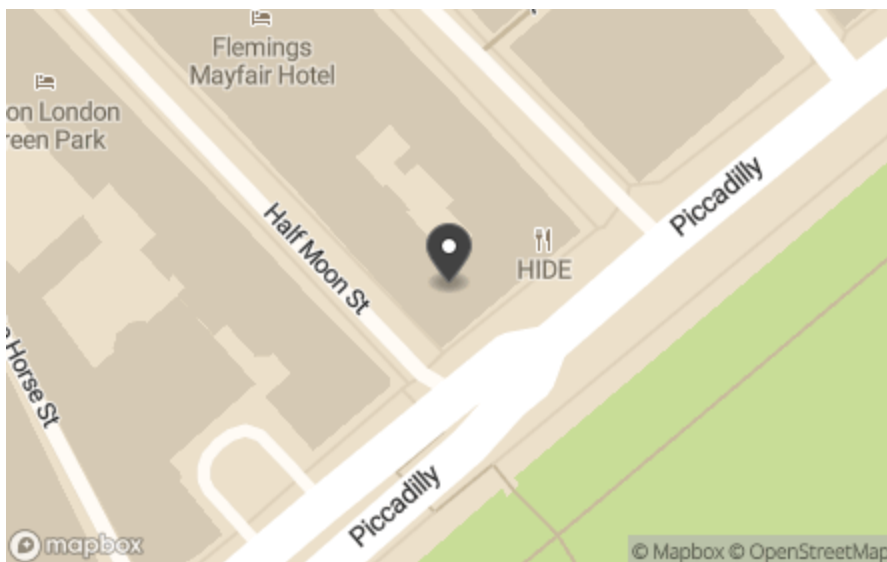



89
VICARILLY

elements green

White van with text on side

Approximate Gross Internal Area 1061 sq ft - 99 sq m

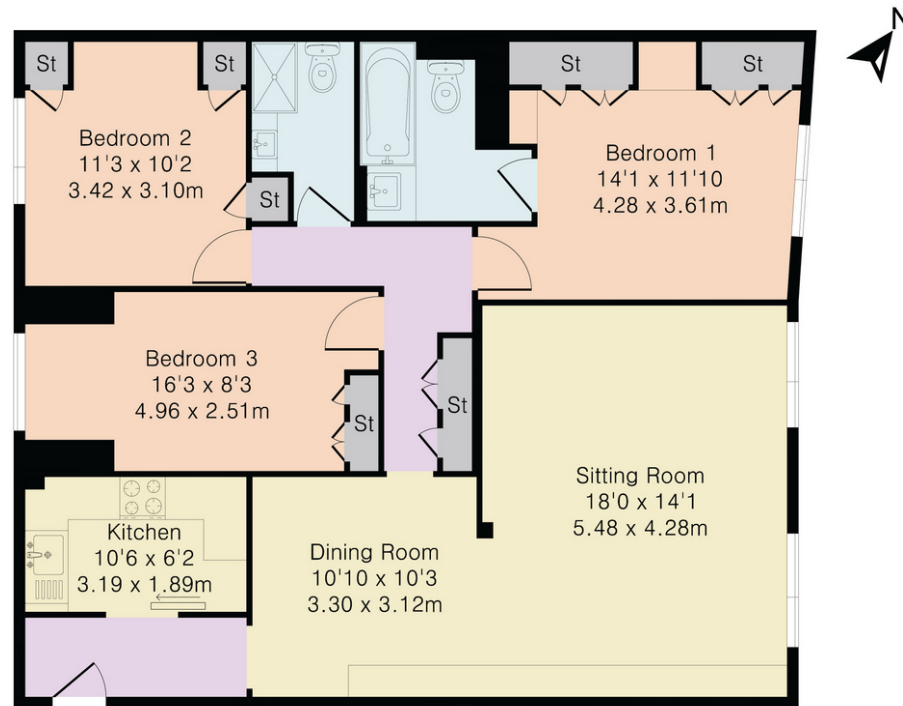

Fifth Floor

TERMS

Price: £2,500,000

Tenure: Leasehold

Council Tax Band: G

Viewing: By appointment only



24 Curzon Street,
London, W1J 7TF

londoninformation@beauchamp.com

020 7499 7722

These particulars have been produced as a general guide for this property only and no other purpose. They are not an offer or contract. You should not rely on statements in these particulars or by word of mouth or in writing as being factually accurate about the property, its condition or its value. Neither any primary agent or joint agent has any authority to make or give any representations or warranties in relation to the property, and accordingly any information given is entirely without responsibility on the part of the agents or lessor(s). The photographs show only certain parts of the property as they appeared at the time they were taken. Any areas, measurements and distances given are approximate only. Any reference to alterations to, or use of, any part of the property does not mean that any necessary planning, building regulations or other consent has been obtained nor have any services, equipment or facilities been tested. A lessee should satisfy themselves by inspection or otherwise. The VAT position relating to the property may change without notice. Please contact us for further information regarding the approved Client Money Protection (CMP) scheme and the property redress scheme which we are a member of.

